

Válvulas retenção F/F

Check valves F/F

Clapets à ressort F/F

Válvulas anti-retorno H/H



01 67 1291 000

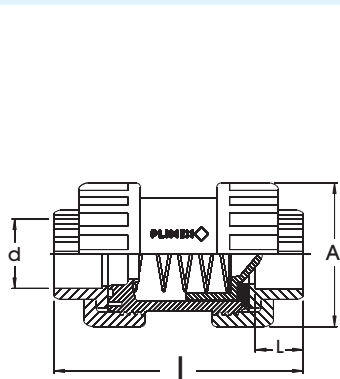

d	A	I	L	Gr	Quant
1/2"	48	84	17	104	B 35
3/4"	68	112	19	270	C 60
1"	68	126	23	277	C 48
1 1/4"	95	149	27	622	C 18
1 1/2"	95	157	31	630	C 18
2"	115	190	38	1080	C 10
3"	185	249	51	3250	C 3
4"	185	266	61	3270	C 3

Nº Código

01 67 1291 020

01 67 1291 025

01 67 1291 032

01 67 1291 040

01 67 1291 050

01 67 1291 063

01 67 1291 090

01 67 1291 110

Válvulas fundo fêmea

Spring foot valves female

Clapets crépine à ressort femelle

Válvulas de pie hembra



01 66 1294 000

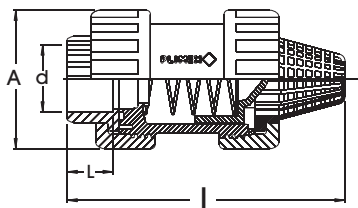

d	A	I	L	Gr	Quant
½"	48	94	17	97	B 35
¾"	68	132	19	249	C 35
1"	68	139	23	256	C 35
1¼"	95	179	27	582	C 18
1½"	95	182	31	586	C 18
2"	115	221	38	1004	C 8

Nº Código

01 66 1294 020

01 66 1294 025

01 66 1294 032

01 66 1294 040

01 66 1294 050

01 66 1294 063

Válvulas retenção porca única F/F

Single union check valves F/F

Clapets à ressort simple union F/F

Válvulas una tuerca anti-retorno H/H



01 55 1291 000

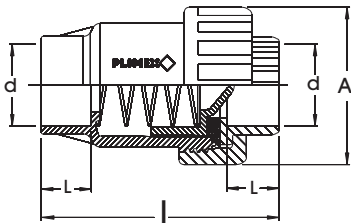

d	A	I	L	Gr	Quant
1/2"	48	75	17	68	B 50
3/4"	68	100	19	175	C 60
1"	68	111	23	190	C 50
1 1/4"	95	135	27	413	C 24
1 1/2"	95	143	31	439	C 24
2"	115	172	38	750	C 13

Nº Código

01 55 1291 020

01 55 1291 025

01 55 1291 032

01 55 1291 040

01 55 1291 050

01 55 1291 063

Válvulas fundo porca única fêmea

Single union spring foot valves female

Clapets crépine à ressort simple union femelle

Válvulas de pie una tuerca anti-retorno hembra



01 56 1294 000

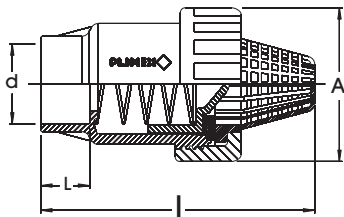

d	A	I	L	Gr	Quant
1/2"	48	85	15	68	B 50
3/4"	68	120	16	175	C 60
1"	68	124	19	190	C 50
1 1/4"	95	148	21	413	C 12
1 1/2"	95	169	22	439	C 12
2"	115	203	26	750	C 12

Nº Código

01 56 1294 020

01 56 1294 025

01 56 1294 032

01 56 1294 040

01 56 1294 050

01 56 1294 063

Terminais de colar fêmea

Union ends female

Pièces folles femelle

Manguitos enlace hembra



01 67 1208 000

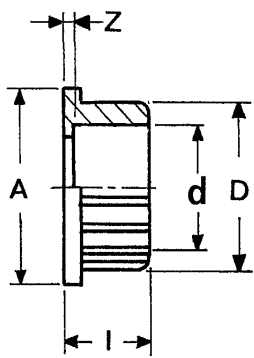

d	A	D	I	Z	Gr	Quant
" 1/2	36	28	20	3	11	A 60
" 3/4	50	36	23	4	25	A 30
1 "	50	42	30	7	29	A 20
1" 1/4	74.5	52	30.5	3.5	60	B 60
1" 1/2	74.5	63	34.5	3.5	64	B 40
2 "	90	77	44	5	117	B 20
2" 1/2	124	91	49	5	220	B 12
3 "	138	111	58	7	363	B 8
4 "	141	132	64	6	351	B 8

Nº Código

01 67 1208 020

01 67 1208 025

01 67 1208 032

01 67 1208 040

01 67 1208 050

01 67 1208 063

01 67 1208 075

01 67 1208 090

01 67 1208 110

Cesto

Foot valve screen

Grille

Cesto

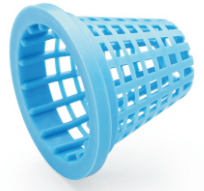

02 61 2290 000

Nº Código

02 61 2290 020

02 61 2290 032

02 61 2290 050

02 61 2290 063

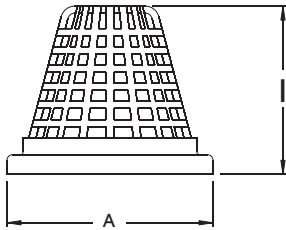

G	d	A	I	Gr	Quant
1/2"	20	35	30	4	A 60
3/4"	25	50	43	8	B 100
1"	32	50	43	8	B 100
1 1/4"	40	73	60	20	B 50
1 1/2"	50	73	60	20	B 50
2"	63	89	75	33	B 24